

1.25

SUPRA

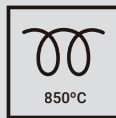

APLICACIONES INDICADAS / SUITABLE APPLICATIONS / APPLICATIONS APPROPRIÉES

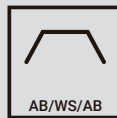
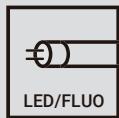
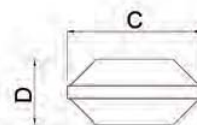
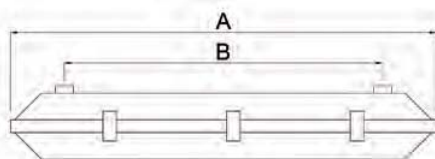

IT - DE



IP65



EN 60598-1



TUBO FLUORESCENTE / LAMP / LAMPE

T8

Ref. Acrylic Acrylique	Ref. PC	Potencia Watts Puissance (W)	Equipo Equipment Ballast	A (mm)	B (mm)	C (mm)	D (mm)	Cierres Fasteners Fermetures	Embalaje Packaging Emballage
S0107	S1107	1 x 18	■	664	260	100	110	6	1
S0108	S1108	1 x 36	■	1.274	870	100	110	8	1
S0109	S1109	1 x 58	■	1.575	650	100	110	12	1
S0119	S1119	2 x 18	■	664	260	160	110	6	1
S0120	S1120	2 x 36	■	1.274	650	160	110	8	1
S0121	S1121	2 x 58	■	1.575	650	160	110	12	1

■ **Electrónica / Electronic / Électronique**

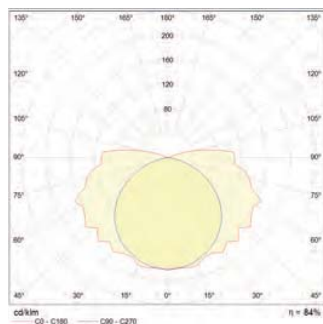

1x

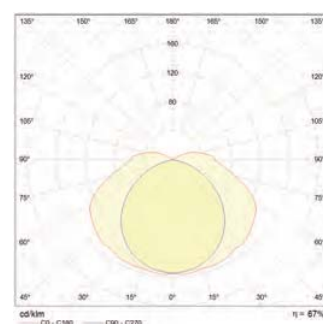

x2x

1.25

SUPRA

TUBO FLUORESCENTE / LAMP / LAMPE

T5

Ref. Acrílico Acrylic Acrylique	Ref. PC	Potencia Watts Puissance	Equipo Equipment Ballast	A	B	C	D	Cierres Fasteners Fermetures	Embalaje Packaging Emballage
		(W)		(mm)	(mm)	(mm)	(mm)		
S2001	S2101	1 x 14	■	664	260	100	110	6	1
S2004	S2104	1 x 24	■	664	260	100	110	6	1
S2002	S2102	1 x 28	■	1.274	870	100	110	8	1
S2003	S2103	1 x 35	■	1.575	650	100	110	12	1
S2005	S2105	1 x 49	■	1.575	650	100	110	12	1
S2006	S2106	1 x 54	■	1.274	870	100	110	8	1
S2007	S2107	1 x 80	■	1.575	650	100	110	12	1
S2008	S2108	2 x 14	■	664	260	100	110	6	1
S2011	S2111	2 x 24	■	664	260	100	110	6	1
S2009	S2109	2 x 28	■	1.274	870	100	110	8	1
S2010	S2110	2 x 35	■	1.575	650	100	110	12	1
S2012	S2112	2 x 49	■	1.575	650	160	110	12	1
S2013	S2113	2 x 54	■	1.274	870	160	110	8	1

■ Electrónica / Electronic / Électronique

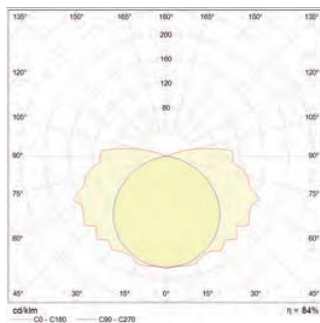

1x

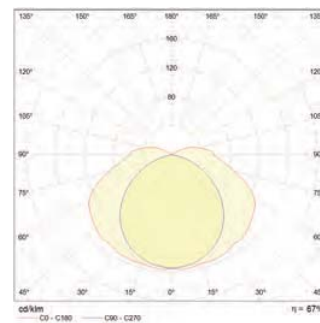

2x

IP65

CE

REFLECTOR ALUMINIO BRILLANTE
 GLOSSY ALUMINIUM REFLECTOR
 RÉFLECTEUR ALUMINIUM BRILLANT

Potencia Watts (W) Puissance	1 x 14/24	1 x 28/54	1 x 35/49/80	2 x 14/24	2 x 28/54	2 x 35/49
------------------------------------	-----------	-----------	--------------	-----------	-----------	-----------

TUBO LED / LED TUBE / TUBE LED

Ref. Acrylic Acrylique	Ref. PC	Longitud Tubo Tube Length Longueur Tube	A	B	C	D	Embalaje Packaging Emballage
		(mm)	(mm)	(mm)	(mm)	(mm)	
S0107L	S1107L	1 x 600	664	260	100	110	1
S0108L	S1108L	1 x 1.200	1.274	870	100	110	1
S0109L	S1109L	1 x 1.500	1.575	650	100	110	1
S0119L	S1119L	2 x 600	664	260	160	110	1
S0120L	S1120L	2 x 1.200	1.274	650	160	110	1
S0121L	S1121L	2 x 1.500	1.575	650	160	110	1

ACCESORIOS SUPRA / SUPRA ACCESSORIES / ACCESSOIRES SUPRA



Ref.

S2150

Grapa de acero inoxidable
 Stainless steel clip
 Clip acier inox



S2151

Sujeción a carril DELTA
 Delta rail fastening
 Platine de fixation sur rail DE TA

LÍNEA CONTINUA
 CONTINUOUS LINE CONNECTION
 CÂBLAGE TRAVERSANT

3 polos / 3 poles / 3 pôles

Ref. S0122

5 polos / 5 poles / 5 pôles

Ref. S0123

1-10
 DALI

EMERGENCY
 1h / 3h